

DATE	APPROVED

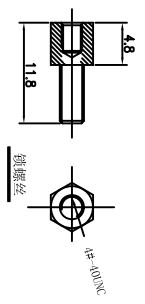
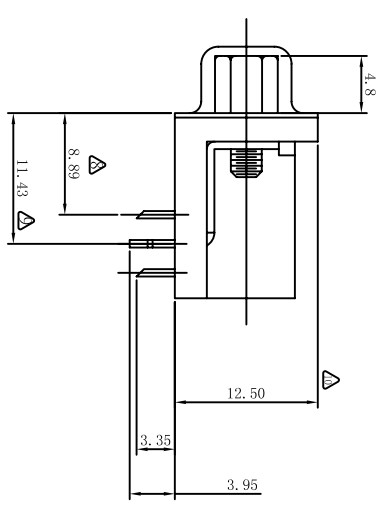
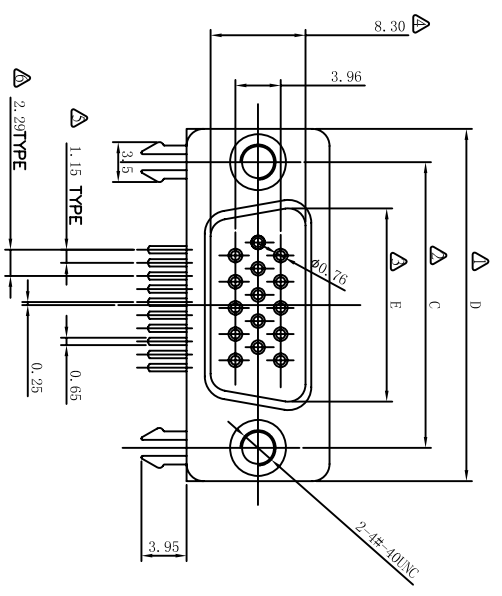

NOTES:  
 INSULATION RESISTANCE (MIN.) : 1000M $\Omega$   
 CURRENT RATING (MAX.) : 3amp AC/ 5amp DC  
 WITHSTANDING VOLTAGE (MAX.) : 500VAC  
 CONTACT RESISTANCE (MAX.) 30m $\Omega$   
 OPERATING TEMPERATURE: -55 $^{\circ}$  ~ +105 $^{\circ}$   
 MATERIAL:  
 CONTACT: BRASS C2680  
 INSULATION: PBT+G, F  
 SHELL: BRASS C2680  
 FINISH:  
 CONTACT: NICKEL AND TIN & AU PLATED  
 SHELL: NICKEL PLATED

HOW TO ORDER

HR - XX M - X XX - X X 0  
 Series: \_\_\_\_\_  
 No. of contacts: \_\_\_\_\_  
 15, 26, 44, 62  
 Contact type: \_\_\_\_\_  
 M: Male  
 F: Female  
 Contact Options  
 T: Traditional  
 S: Simple  
 Contact Plating  
 00: Tin All flash  
 01: Gold flash  
 11: Gold All flash  
 03: 3u" gold

Mounting options  
 O:  
 Options  
 0: Black Insulator  
 1: White Insulator  
 2: Blue Insulator  
 Mating Options  
 0: Riveting  
 1: Riveting with screws  
 2: Fork lock  
 3: Rivet lock

P. C. B LAYOUT

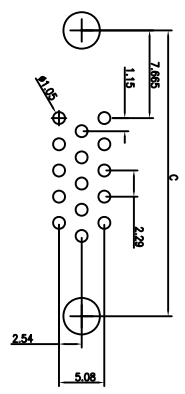

	C	D	E
15P	24.99	30.81	16.90
26P	33.32	39.20	25.30
44P	47.04	53.10	39.00
62P	63.50	70.00	55.40

TOLERANCE	Drawn	Stone	14.03.04
.X	$\pm 0.38$	Angela	14.03.04
.XX	$\pm 0.25$	Kevin	14.03.04
.XXX	$\pm 0.15$		

Angles + \ -5 $^{\circ}$

Ver A0

D-sub PCB 90 $^{\circ}$  Type Connector  
 HDR15-62P Male

东莞市亚当电子科技有限公司  
 DONGGUAN ADAM ELECTRONIC TECHNOLOGY CO.,LTD

SHEET 1/1 Scale: 1:1

Part No. HR-XXM-XXX-XX0

ROHS